

BC8303  
V-Hush Lite



**vtech**  
Quick Start Guide

**TECHNICAL SPECIFICATIONS**

Frequency	2402 - 2480 MHz
Channels	79
Nominal effective range	Actual operating range may vary according to environmental conditions at the time of use.
Power requirements	Soother power adaptor: Input: 100-240V~50/60Hz 0.15A; Output: 5V DC 1A

**WHAT'S IN THE BOX**

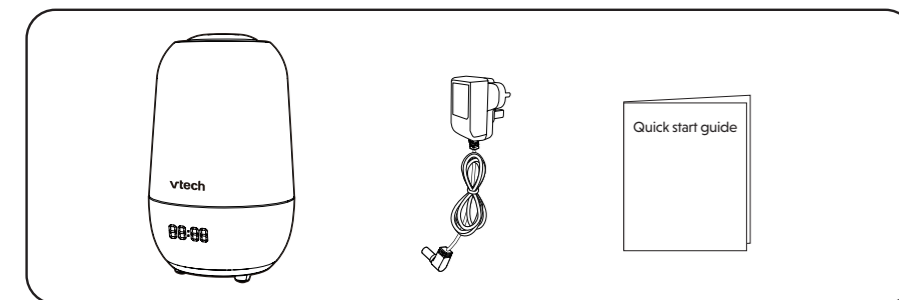

**IMPORTANT SAFETY INSTRUCTIONS**

- The applied nameplate is located at the bottom of the soother base.
- When in use, basic safety precautions should always be followed to reduce the risk of fire, electric shock and injury, including the following:
- Follow all warnings and instructions marked on the product.
  - Adult setup is required.
  - This product is intended as an aid. It is not a substitute for responsible and proper adult supervision and should not be used as such.
  - This product is not intended for use as a medical monitor.
  - Do not use this product near water. For example, near to a bath, sink, swimming pool or shower.
  - Use only the adaptor included with this product. Incorrect adaptor polarity or voltage can seriously damage the product.
  - The power adaptor is intended to be correctly oriented in a vertical or floor mount position. The prongs are not designed to hold the plug in place if it is plugged into a ceiling.
  - For pluggable equipment, the socket-outlet (power adaptor) shall be installed near the equipment and shall be easily accessible.
  - Unplug this product from the wall outlet before cleaning. Do not use liquid or aerosol cleaners. Use a damp cloth for cleaning.
  - Do not modify the power adaptor or replace with other third-party adaptor.
  - Do not allow anything to rest on the power cords. Do not install this product where the cords may be walked on or damaged.
  - The product should only be operated from a power source indicated on the power adaptor label or marking. If you are unsure of the type of power supply in your home, consult your dealer or electricity supply provider.
  - Do not overload wall outlets.
  - Do not place this product on an unstable table, shelf, stand or other unstable surfaces.
  - This product should not be placed in any area where proper ventilation is not provided. Any slots or openings in the back or bottom of this product are provided for ventilation. To protect from overheating, openings must not be blocked by placing the product on a soft surface such as a bed, sofa or rug. This product should never be placed near or over a radiator or heat source.
  - Never insert objects into apertures on the product as dangerous voltages exist inside.
  - Never spill liquid of any kind on the product.
  - To reduce the risk of electric shock, do not disassemble this product. Disassembling or removing parts of the product may expose you to dangerous voltages or other risks.
  - Periodically examine all components for damage.
  - There is a very low risk of privacy loss when using certain electronic devices, such as baby monitors, cordless telephones, etc. **To protect your privacy, make sure the product has never been used before purchase, reset the soother periodically by**

- powering off and then powering on the units, and power off the soother if you are not intending to use it for some time.**
- Children should be supervised to ensure that they do not play with the product.
  - The product is not intended for use by persons (including children) with reduced physical, sensory or mental capabilities, or lack of experience and knowledge, unless they have been given supervision or instruction concerning use of the appliance by a person responsible for their safety.
  - Baby Sleep Soother is a class III product.
  - This product is for indoor use only.
  - Warning:** The light sources used in the Soother are not user-replaceable. When the lights eventually reach end of life, the complete Soother will need to be replaced.

- SAVE THESE INSTRUCTIONS**
- Cautions**
- Use and store the product at a temperature between 0°C and 40°C.
  - Do not expose the product to extreme cold, heat or direct sunlight. Do not put the product close to a heating source.
  - Warning—Strangulation Hazard—Children have STRANGLED in cords.** Keep this cord out of the reach of children (more than 3 ft (0.9m) away). Do not remove warning label on the adaptor cord.
  - Never place the soother inside the baby's cot or playpen. Never cover the soother with anything such as a towel or a blanket.
  - Other electronic products may cause interference with your soother. Try installing your soother as far away as possible from these electronic devices as possible: wireless routers, radios, mobile telephones, intercoms, room monitors, televisions, personal computers, kitchen appliances (e.g. microwave ovens) and cordless telephones.
  - Do not allow your child or anyone to look directly into the projector lens while it is turned on to avoid possible eye damage.

**1 CONNECT AND POWER ON THE SOOTHER**

- NOTES**
- Only use the power adaptor supplied with this product.
  - Make sure the soother is not connected to an electronically/timer controlled electric power outlet.
  - Make sure the soother and the power adaptor cord are out of reach of children.

Connect the power adaptor to the soother and a power supply, then the soother powers on automatically.

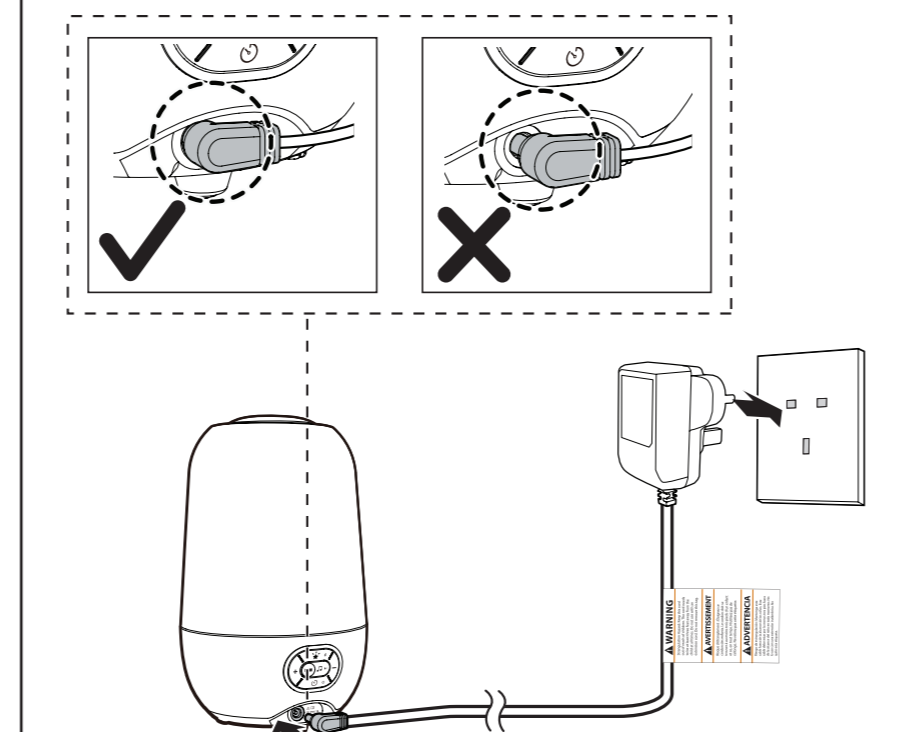

**2 BEFORE USE**

**Positioning the soother**

- Place the soother around 1 - 1.5 metres away from your baby.
- CAUTION**
- Keep the soother out of the reach of your baby. Never place the soother inside the baby's cot or playpen.
- NOTE**
- To avoid interference from other electronic devices, place your soother at least 1 metre away from devices such as wireless routers, microwaves, mobile phones and computers.
  - Do not insert the soother in the same socket as these devices.

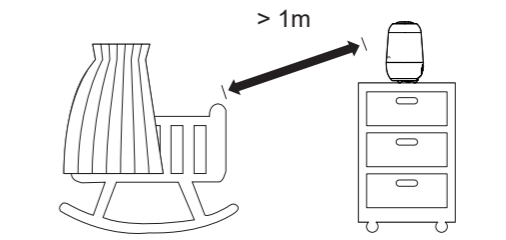

**DOWNLOAD THE APP**

**Download MyVTech Soother app for more premium features**

- Download **MyVTech Soother** app to your mobile device from Apple Store or Google Play store to gain full access of features and conveniently control your soother. Put advanced functions to action, like customizing a routine, with just a few taps of the finger. With **MyVTech Soother** app, you can pamper your baby.
- TIP**
- Make sure your mobile device meets the minimum requirement for the mobile app.
- NOTE**
- The mobile app is compatible with:
- Android™ 6.0 or later; and
  - iOS 12 or later.

**Step 1**  
**Install MyVTech Soother App**

- Browse the App Store or the Google Play store.
- Search for the mobile app with the keyword **"MyVTech Soother"**.
- Download and install the **MyVTech Soother** app to your mobile device.

**-OR-**  
Scan the QR code below to install the app.

**Step 2**  
**Connect both devices via Bluetooth**

- Follow the instructions in the mobile app to set up and pair your soother.
- Tap the app icon to run the mobile app in your mobile device, and set your mobile device to Bluetooth discoverable mode.
  - The Soother will start searching for nearby devices automatically after being powered on.
  - Select **V-Hush Lite** under the list of available devices and wait a short time for the pairing process to complete.
- NOTES**
- Make sure your soother is powered on before pairing.
  - Move your mobile phone near to the Soother to improve the connection.

**APP FEATURES**

**3 OVERVIEW**

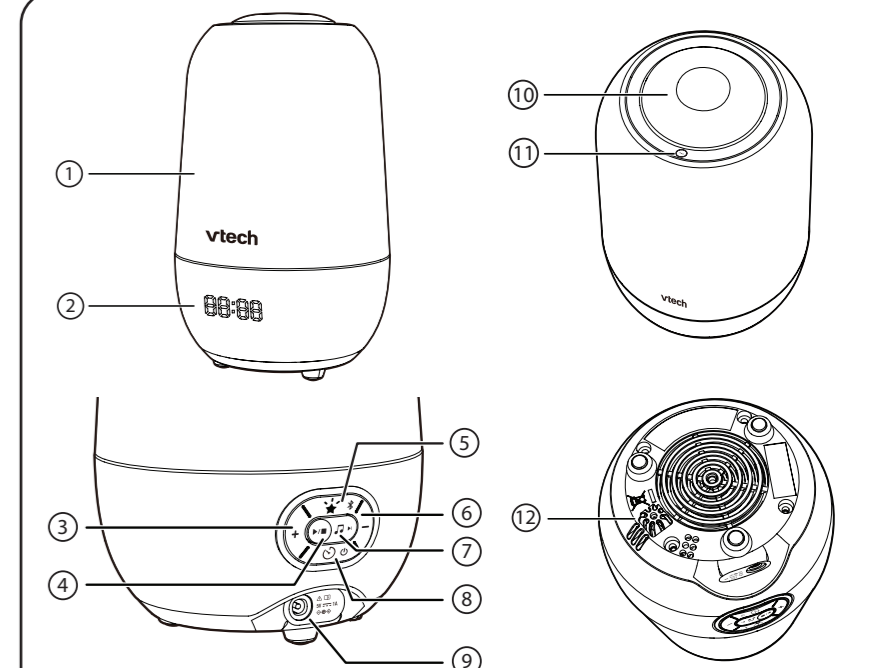

- Night light**
- Digital display**
- + VOLUME**
  - Press to increase the soother speaker volume.
- ▶/■ Play/Stop**
  - Press to play the audio mode/sound selected and press again to stop playing.
- ★ Film projection On/Off key**
- ✳ Bluetooth pairing key**
  - Press and hold for 5 seconds to enter the Bluetooth pairing mode.
- VOLUME**
  - Press to lower the soother speaker volume
- 🎵 Audio key**
  - Press and hold to change among 4 different modes including natural sound, lullaby, classical music and storytelling.
- ▶| Skip**
  - Press to skip to the next track/sound/story.
- 🔌 On/Off switch**
  - Press to turn on or turn off the soother.
- 🕒 Timer**
  - Press to select the time interval options and release to start the countdown.
- 🔌 Power jack**
- 🎬 Film projector**
- Magic key**
- 🌡️ Temperature sensor**

## USE THE SOOTHER

### Film Projection

The projection light is located on top of the soother, offering 6 selectable patterns for your baby. The selected pattern will be projected on the ceiling at an angle.

#### Turn on or turn off the projection

- Press the **Film projection On/Off key**  to turn on or turn off the projection.

#### Adjust the projection angle

- Tilt the projection light lens manually to try out different angles then pick the one which suits your baby the best.
- Adjust your soother's position with the projection light to help soothe your baby to sleep. For optimal performance, place the soother in an upright position.

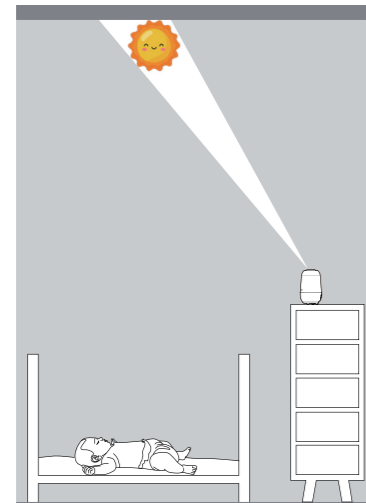

### Magic Key

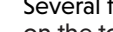
Several functions can be performed using the **Magic key**  located on the top of the soother.

#### Start or stop the soother

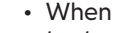
- When inactive, tap the **Magic key**  to start and resume the soother to its previous settings.
- When active, tap the **Magic key**  to stop the soother.

#### Change your favourite mode

- Tap the **Magic key**  twice to go to the next favourite mode.

#### Adjust the night light brightness

With the night light, the soother can illuminate a soft hue to calm your baby in a dark room. You can control the brightness level of the glow directly from the soother and adjust the night light colour remotely in **MyVTech Soother** app.

- Tap and hold** the **Magic key**  to adjust the night light brightness level.

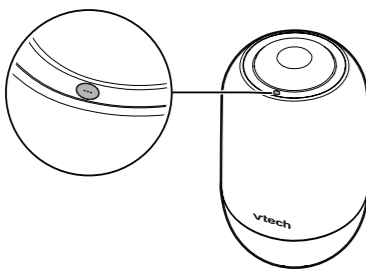

### Audio Player

A selection of audio content comes in handy, including soothing sounds, lullabies, classic music and stories. All sounds come pre-stored in the soother.

#### Play or stop the audio

- Press  to play sounds, music or stories and press again to stop playing.

#### Change the audio mode

- Press and hold**  to change among 4 different modes following below sequence.
  - Natural sound
  - Lullaby
  - Classical music
  - Storytelling

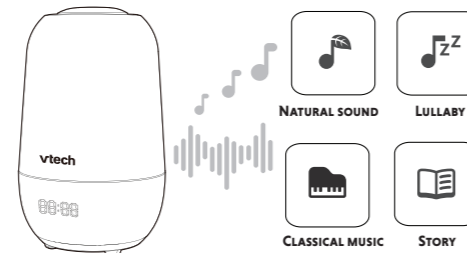

#### Skip an audio

- Press  to skip the current song and play the next one.

#### Adjust the volume





- Press **+** or **-** to increase or decrease the volume.

#### CAUTION

- Beware of the speaker volume. For ear protection, the maximum volume is set to **Level 6** by default (**Level 1** - the lowest to **Level 10** - the highest). If you want to set the volume level higher than **Level 6**, you can adjust it in **MyVTech Soother** app.

#### NOTES

When an audio is playing, two letters before the colon will be shown on the digital display. It represents the audio mode you are currently in and the track currently playing.

-  stands for Lullaby mode.
-  stands for Classical music mode.
-  stands for Storytelling mode.
-  stands for Natural sound mode.

### Get the latest MyVTech Soother app instructions



Scan the QR code to access the latest app instructions for better control and adjustment of the soother.



### Auto-off Timer

While the soother is playing a story, lullaby, classical music or natural sounds, the auto-off timer feature helps you automatically stop the projection, light and sounds from playing after 30, 60, 120, 180 or 240 minutes.

#### Set auto-off timer

- Toggle  to select timer options **OFF, 30 minutes, 60 minutes, 120 minutes, 180 minutes** or **240 minutes**.
- Stop pressing  to start the countdown.
- Toggle  back to **OFF** to stop countdown.

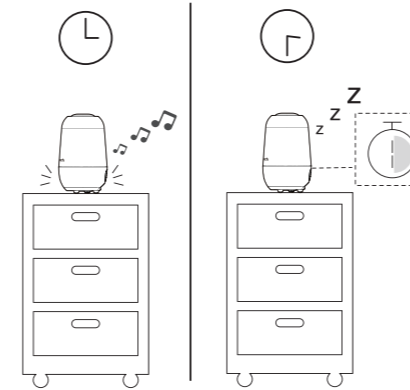

### Temperature and Time

Once the Soother is turned on, the room temperature is detected automatically. The measurement is shown on the digital display. The soother clock will activate after pairing with the mobile, and display with the temperature alternately. The soother clock will synchronise with your mobile device after pairing.

#### TIP

The following items can be adjusted from the **MyVTech Soother** app.

- Temperature format
- 12-hour or 24-hour time format
- Temperature and time rotation interval.

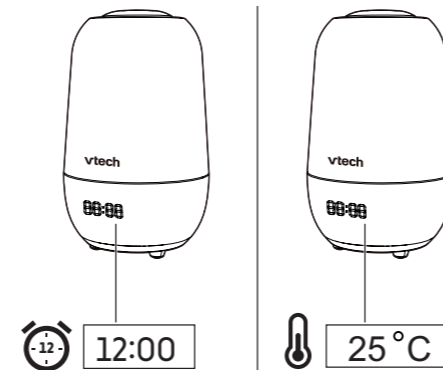

### Audio streaming from your mobile device

The Soother can function as a Bluetooth Speaker after pairing with a mobile device with Bluetooth, allowing your own music to be played through the soother.

#### Connect your device with the soother via Bluetooth audio

To use a Bluetooth enabled mobile device with your Soother, you must first pair and connect your Bluetooth mobile device with the Soother, **which is a different connection from the separate MyVTech Soother app Bluetooth connection**. Before you begin, make sure that your Bluetooth enabled mobile device is not connected to any other Bluetooth device.

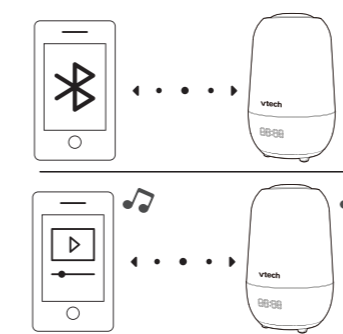

#### On the soother

- Press and hold** the Bluetooth pairing key  for 5 seconds to enter Bluetooth pairing mode.

#### On your device

- Set your mobile device to discoverable mode before pairing.
- Place you mobile device next to the soother during the whole pairing process.
- Select "V-Hush Lite Speaker" under the device list.

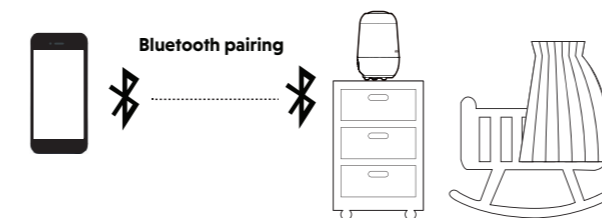

#### NOTE

- After the Soother enters Bluetooth pairing mode, the word **BLUE** will continue to flash on the digital display.

## CUSTOMER SERVICE AND PRODUCT WARRANTY



### PRODUCT WARRANTY

Thank you for choosing this quality product from VTech.

- The product detailed above is covered by a one year warranty from the date of purchase, against any defects in materials or workmanship.
- The product may be returned to the place of purchase.
- If the product covered by this warranty is damaged due to misuse, modification or unauthorised repair, or because of faulty batteries, battery discharge or incorrect electrical connections, then this warranty becomes void.
- This warranty is personal to the original purchaser and is not transferable.
- Breakages to the LCD screen are not covered by the warranty.
- Damage to the antenna is not covered by the warranty.

Email: [service-ukbm@vtechphones.eu](mailto:service-ukbm@vtechphones.eu)

VTech Electronics Europe Plc, c/o XPO Logistics, Warehouse 350, Cat & Fiddle Lane, West Hallam, DE7 6HE

THIS WARRANTY IS OFFERED AS AN EXTRA BENEFIT AND DOES NOT AFFECT CONSUMERS' STATUTORY RIGHTS.

This warranty is valid for the UK and Ireland only. For products purchased outside the UK and Ireland, please contact your local distributor or place of purchase.

## CUSTOMER SUPPORT

Find the answer to your questions and get assisted at your own pace. **Scan the QR code to access the website or visit [www.vtechphones.eu](http://www.vtechphones.eu)**



#### IMPORTANT

Please retain the receipt as proof of the date of purchase.

#### Customer Service

Please visit [www.vtechphones.eu](http://www.vtechphones.eu) to contact our Customer Service Department.

Manufacturer: VTech Telecommunications Ltd.  
23/F., Tai Ping Industrial Centre, Block 1, 57 Ting kok Road, Tai Po, Hong Kong.  
Importer: VTech Electronics Europe Plc  
Napier Court, Abingdon Science Park, Abingdon, Oxon, OX14 3YT, U.K.

## GENERAL PRODUCT CARE

To keep this product working well and looking good, please follow these guidelines:

- Avoid placing near heating appliances and devices that generate electrical noise (for example, motors or fluorescent lamps).
- DO NOT** expose to direct sunlight or moisture.
- Avoid dropping the product or treating it roughly.
- Clean with a soft damp cloth.
- DO NOT** immerse the soother in water and do not clean under running water.
- DO NOT** use solvents, household cleaning sprays, or liquid cleaners.
- Make sure the soother is dry before reconnecting to the mains supply.

## STORAGE

When you are not intending to use the Soother for some time, store the product and the adaptor in a cool, dry place.

## DISPOSAL OF BATTERIES AND PRODUCT



The crossed-out wheelee bin symbols on products and batteries, or on their respective packaging, indicates that they must not be disposed of with domestic waste as they contain substances that can be damaging to the environment and human health.

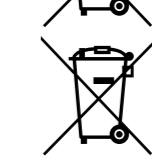

The chemical symbols Hg, Cd or Pb, where marked, indicate that the battery contains more than the specified value of mercury (Hg), cadmium (Cd) or lead (Pb) set out in Battery Directive (2006/66/EC).

The solid bar indicates that the product was placed on the market after 13th August, 2005.

Help protect the environment by disposing of your product or batteries responsibly.

## DECLARATION OF CONFORMITY

This product is intended for use within Europe and UK.

This equipment complies with the essential requirements of EU Radio Equipment Directive (2014/53/EU) and the UK Radio Regulations 2017 on radio systems and telecommunication equipment.

VTech Telecommunications Ltd. hereby declares that Baby Sleep Soother BC8303 complies with the essential requirements and other relevant provisions of EU Radio Equipment Directive (2014/53/EU) and UK Radio Equipment Regulations 2017. The Declaration of Conformity for the Baby Sleep Soother BC8303 is available from [www.vtechphones.com](http://www.vtechphones.com).



Specifications are subject to change without notice.  
© 2024 VTech Telecommunications Ltd.  
All rights reserved. 04/24. BC8303\_UK\_EU\_QSG\_V1

